

1. Remove snap ring and washer (*diagram 1*).
2. Replace with rotational stop plate (*diagram 2*). Fasten with snap ring and two (2) #10-32 flat head screws. Do not reuse washer.
3. Align rotation stop plate on jib crane's vertical shaft and fasten with two (2) #10-32 flat head screws (*diagram 2*). Tighten.
4. Pre-assemble plunger lock with spring and retainer block. Align holes of cam lever lock and plunger lock. Side clevis pin through holes and fasten with e-clip (*diagram 3*).
5. Align brake pad with retainer block. Fasten using two (2) #10 lockwashers and two (2) #10-32 socket head screws (*diagram 3*). Do not fully tighten screws yet.
6. Align pre-assembled plunger lock assembly to jib crane shaft. Slide assembly until both holes line up. Secure using slotted spring pin (*diagram 4*).
7. Attach S-hook to cam lever lock (*diagram 5*). Crimp hook.
8. Tighten brake pad screws until desired level of friction is achieved. Do not exceed 15 in.-lbs. of torque.

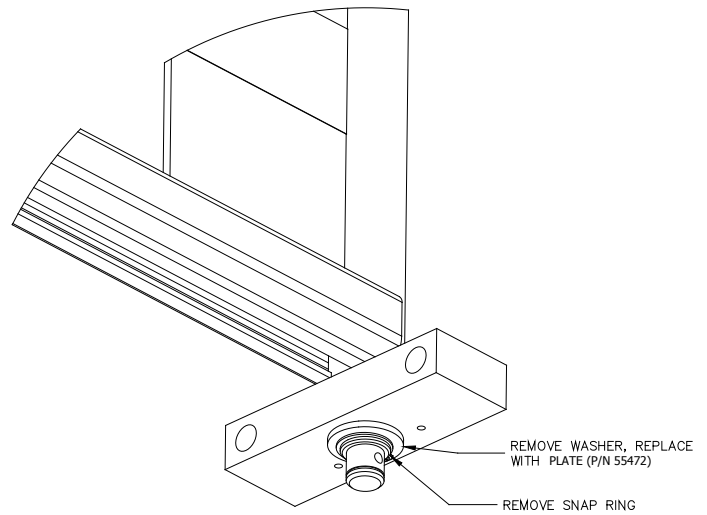

Diagram 1.

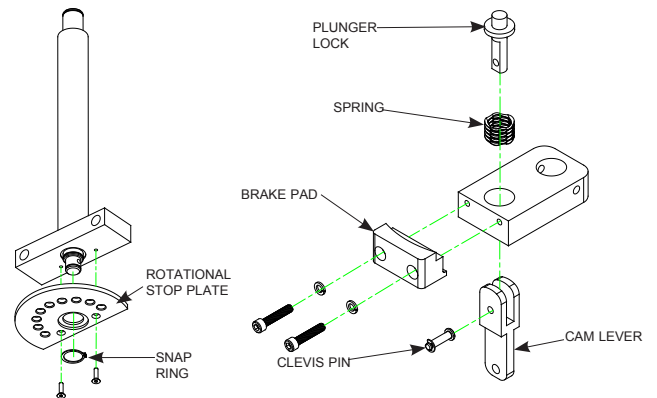

Diagram 2.

Diagram 3.

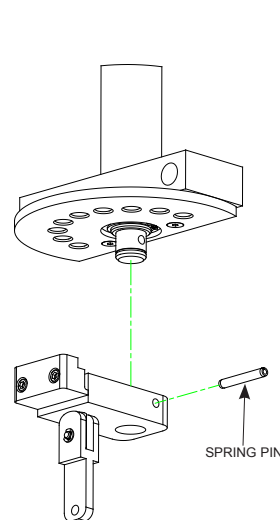

Diagram 4.

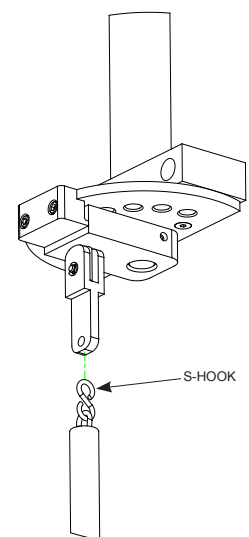

Diagram 5.